

South Carolina Pursuant to a warrant (265) from John Thomas Esq. Com. of Saluda. I have measured & laid out unto Thomas Aikins a tract of 1000 acres of land situate in the late purchase made from the Cherokee Indians on the main fork Green river in Greenville County, N.C. on land of P. Aikins, all other sides vac. and hath such form marks as the above plat represents. Surveyed the 13th Nov, 1787

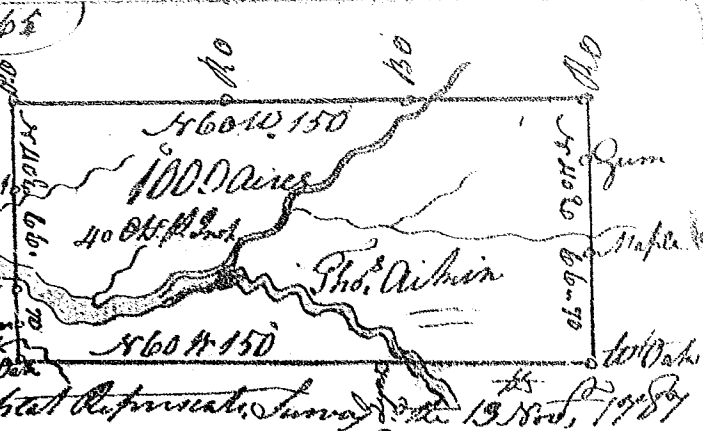

Recorded the 20th Nov, 1787
 South Carolina Pursuant to a warrant from John Thomas Esq. Com. of Saluda. I have measured & laid out unto Thomas Aikins a tract of 1000 acres of land situate in Greenville County in late purchase made from the Cherokee Indians, on theuddy fork of Saluda. Bounding side on land of S. Aikins, all other sides vac. and hath such form marks as the above plat represents. Surveyed the 14th Nov, 1787



Recorded 20th Nov. 1787
 State of Carolina Pursuant to a warrant from John Thomas Esq. Com. of Saluda. I have measured & laid out unto Thomas Aikins a tract of 1000 acres of land situate in Greenville County in the late purchase made from the Cherokee Indians, on the uddy fork of Saluda River. Bounding side on land of S. Aikins, all other sides vac. and hath such shape form and other marks as the above plat represents. Surveyed the 14th Nov, 1787

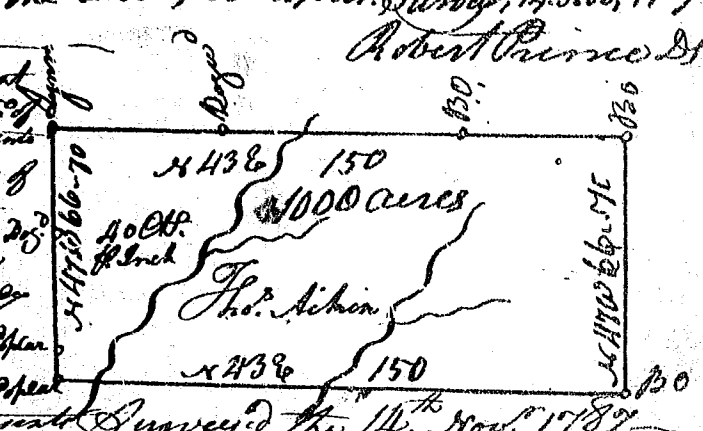

Recorded the 20th Nov. 1787
 South Carolina Pursuant to a warrant from John Thomas Esq. Com. of Saluda. I have measured & laid out unto Thomas Aikins a tract of 1000 acres of land situate in the late purchase made from the Cherokee Indians in Greenville County on the waters of the uddy fork of Saluda River. Bounding N.E. & S.E. on land of the S. Aikins, all other sides vac. Land I hath such form marks as the above plat represents. Surveyed 14th Nov. 1787

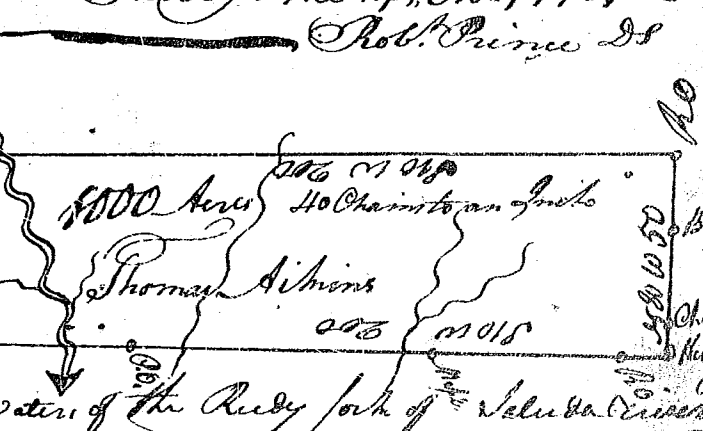

Recorded the 20th Nov, 1787

